

# T-DRILL

PRODUCTIVITY AS A PRODUCT.



## COLLARING MACHINE

High-speed Fully Automatic Collaring Machine with Fully Servo Controlled Process

# S-80



## S-80 Collaring Machine

**T-DRILL** fully automatic collaring machine **S-80** with tool changer is an ideal machine for the production of manifolds with multiple collar diameters. S-80 is suitable for stainless steel, steel, copper, and aluminum manifold production with multiple collar diameters.

\*As an option different manual and automatic tube feeding systems are available.

The **S-80** has a fully automatic collaring cycle: 1. Pilot hole milling, 2. Collar forming and 3. Trimming for the collars to be welded. The collaring tool is adjusted automatically according to programmed collar diameter, so no manual tool adjustment is needed.



## THE T-DRILL PROCESS

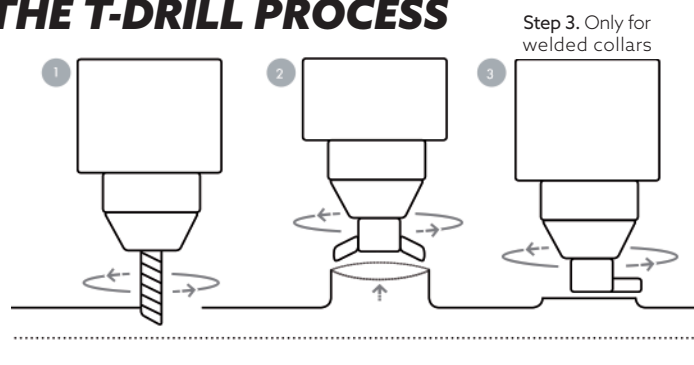

## Capacity | Max. wall thicknesses

		Collar outside diameter												
		Mild Steel & Stainless Steel												
		12	13,7	17	19,05	21,3	26,9	33,7	42,4	48,3	60,3	76,1	88,9	101,6
		NS ½"	¼"	¾"	¾"	½"	¾"	1"	1¼"	1½"	2"	2¼"	3"	3½"
Run tube outside diameter	26,9 NS ¾"	1,0 0,0393	1,0 0,0393	1,5 0,059	1,5 0,059	1,5 0,059	2,6 0,102	-	-	-	-	-	-	-
	33,7 1"	1,0 0,0393	1,0 0,0393	1,5 0,059	1,5 0,059	2,0 0,079	2,6 0,102	2,6 0,102	-	-	-	-	-	-
	42,4 1¼"	1,0 0,0393	1,0 0,0393	1,5 0,059	1,5 0,059	2,0 0,079	2,6 0,102	2,9 0,114	2,9 0,114	-	-	-	-	-
	48,3 1½"	1,0 0,0393	1,0 0,0393	1,5 0,059	1,5 0,059	2,0 0,079	2,6 0,102	2,9 0,114	2,9 0,114	2,9 0,114	-	-	-	-
	60,3 2"	1,0 0,0393	1,0 0,0393	1,5 0,059	1,5 0,059	2,0 0,079	2,9 0,114	2,9 0,114	2,9 0,114	3,05 0,120	3,05 0,120	-	-	-
	76,1 2¼"	1,0 0,0393	1,0 0,0393	1,5 0,059	1,5 0,059	2,0 0,079	2,9 0,114	2,9 0,114	3,05 0,120	3,05 0,120	3,05 0,120	3,05 0,120	-	-
	88,9 3"	1,0 0,0393	1,0 0,0393	1,5 0,059	1,5 0,059	2,0 0,079	3,05 0,120	3,05 0,120	3,05 0,120	3,05 0,120	3,05 0,120	3,05 0,120	2,6 0,102	-
	101,6 3½"	1,0 0,0393	1,0 0,0393	1,5 0,059	1,5 0,059	2,0 0,079	3,05 0,120	3,05 0,120	3,05 0,120	3,05 0,120	3,05 0,120	3,05 0,120	3,05 0,120	2,0 0,079
	114,3 4"	1,0 0,0393	1,0 0,0393	1,5 0,059	1,5 0,059	2,0 0,079	3,05 0,120	3,05 0,120	3,05 0,120	3,05 0,120	3,05 0,120	3,05 0,120	3,05 0,120	2,0 0,079

## Technical data

Steels	
Collaring range	12 - 101,6 mm / NS ½" - 3 ½"
Run tube size	26,9 - 114,3 mm / NS ¾" - 4"
Rated power	15 kW
Weight (basic unit)	1 200 kg
Noise level	73dB(A)

The information included in this brochure is subject to revision without notice.

## DO IT WITH T-DRILL

Cut costs – Improve quality – Increase profit

- No T-fittings
- No costly inventories
- No tube cutting

- Only one welded/brazed joint
- Minimized inspection cost
- Tee ratio variation flexibility

- Smaller risk of leakage or call-backs
- Optimized flow-characteristics

MANUFACTURER:

# T-DRILL

T-DRILL OY  
Ampujantie 32, FIN-66400,  
Laihia, FINLAND  
Tel. +358 6 475 3333  
sales@t-drill.fi  
www.t-drill.com

REPRESENTED BY:

T-DRILL Industries Inc.  
1740 Corporate Drive,  
Suite #820, Norcross,  
Georgia 30093 USA  
Tel. +1-770-925-0520,  
sales@t-drill.com  
www.t-drill.com